

119° LNB

110° LNB

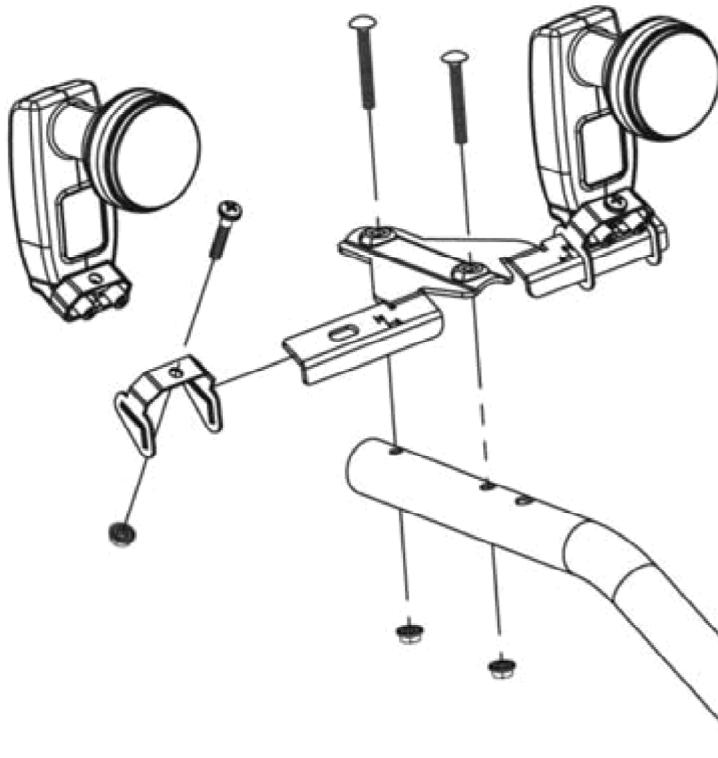

119° LNB

110° LNB

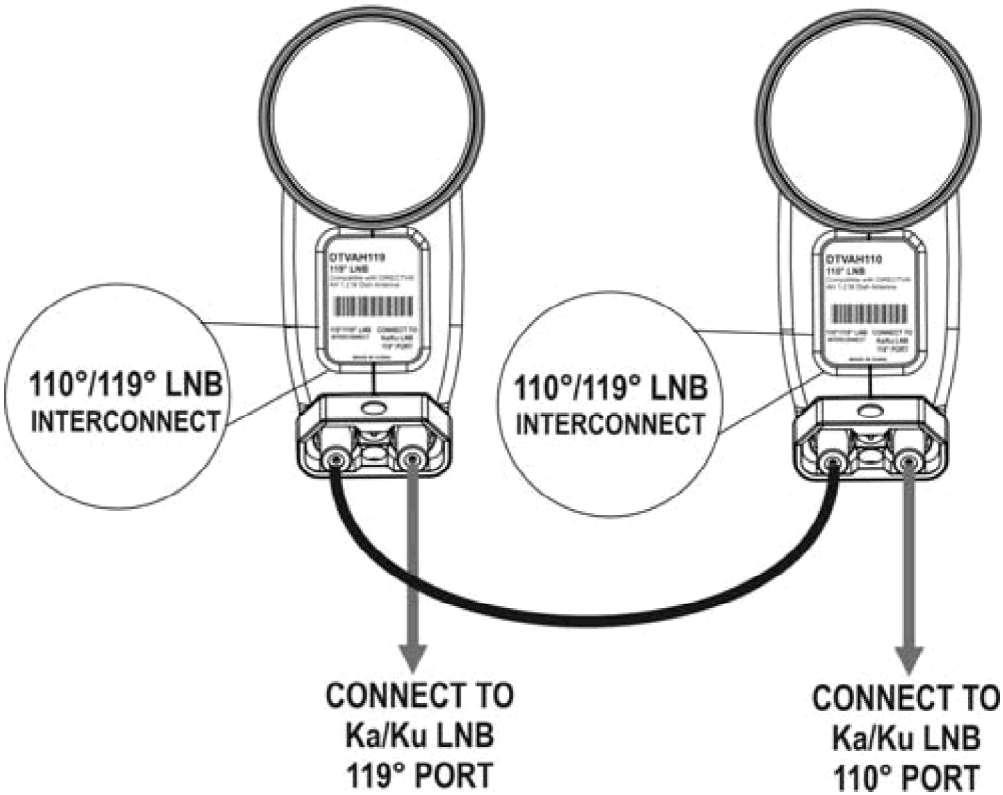

- 1) Attach LNB mounting bracket to the feed tube as shown, using 2pc 1/4x 2" bolts & 1/4" nuts. Note: Each LNB is different, ensure proper placement as shown above.
- 2) Slide the LNB collars (2pc) onto each side of the LNB mount bracket and place the neck of the LNB inside collars. Use 1pc 1/4" x 1 3/8" bolt and 1/4" nut to attach each LNB. Set LNB position to "A" for Alaska or "H" for Hawaii, and tighten the bolt.
- 3) Connect 110° 119° LNB as shown, using 12" coax jumper (included). Note: This jumper must be connected or the system will not work.
- 4) Determine length of coax cable needed to connect 110° 119° LNB's to the 99° 101° 103° LNB and connect open ports to corresponding open ports located on side of 99° 101° 103° LNB. Note: 110° 119° LNB's must be connected properly or the system will not work. Do NOT exceed 20' of coaxial cable between 110° 119° & 99° 101° 103° antennas!

NOTE: DO NOT CONNECT 110° 119° LNB'S DIRECTLY TO RECEIVER

The 110° 119° are designed and will only operate when connected to the 99° 101° 103° LNB.

- 5) With Antenna TILT/SKEW, AZIMUTH & ELEVATION set for your site, set the receiver to 119°. Align the antenna for maximum signal. Check that 110° & 119° have comparable (balanced) signal readings. A small adjustment to the TILT/SKEW may be required to balance the signal levels.
- 6) When maximum signal level has been peaked, tighten all antenna mount adjustment bolts according to the directions provided with the antenna system.
- 7) Secure/Dress all coax cables and make sure all LNB bracket attachment hardware is tightened.

New Page 1

110° 119° LNB KIT

ASSEMBLY INSTRUCTIONS

MODEL DTVAH1019KIT

SatelliteDish.com

(954) 941-8883