

SPECIFICATIONS

FREQUENCY BAND: 4.5 - 4.8 GHz
 INSERTION LOSS: 0.10 dB
 VSWR: 1.10:1 MAX
 ISOLATION: 65 dB AT 6.725-7.025 GHz
 PRESSURIZATION: SEALED TO 2 PSIG

FINISH: INTERIOR
 AND FLANGE FACES: SILVER PLATED
 EXTERIOR: WHITE PAINT, COLOR
 NO. 17875 PER FED-STD-595

REVISIONS

REV	DESCRIPTION	DATE	APPROVED
C	SEE REVISION RECORD SHT	05-21-03	H.S.

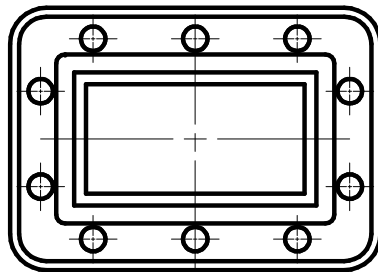

**WR229 CPRG
 FLANGE PATTERN
 TYPICAL BOTH ENDS**

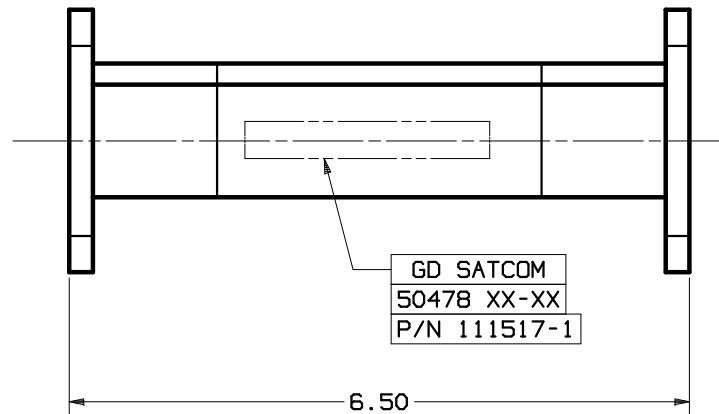

UNLESS OTHERWISE SPECIFIED		APPROVALS	DATE	GENERAL DYNAMICS PROPRIETARY	
INTERPRET DIMENSIONING & TOLERANCING PER ANSI Y14.5M-1982. DIMENSIONS ARE IN INCHES. DIMENSIONS SHOWN IN () ARE FOR REFERENCE ONLY. TOLERANCES ARE: SURFACE- TOLERANCES- .XX ±.02 .XXX ±.005 .XXXX ± ANGLES ±0°30'		DRAWN: TOVALIN	07-05-96	GENERAL DYNAMICS SATCOM Technologies 3111 Fujita St., Torrance, CA 90505, (310) 539-6704	
		CHECKED: H.Spieleder	07-05-96		
		ENGRS:			
		MFG:			
MATERIAL: ALUMINUM CASTING		GA:		C-BAND TRANSMIT ReJECT FILTER	
		EAR CONTROLLED: Export or re-export subject to 15 CFR 700-799.			
NOTES: UNLESS OTHERWISE SPECIFIED.		SIZE: C	FSCM No. 50478	DWG No. 111517-1	REV C
		SCALE: 1:1	SHEET 1		

NOTES: UNLESS OTHERWISE SPECIFIED.