

Waveguide to Coaxial SMA Adapters



Waveguide Adapter Description

- 1.70 - 40.00 GHz Performance Frequency
- 1.25 Typical Max VSWR (VSWR varies with design)
- Male or Female Connectors available
- Numerous Flange Configurations available
- Aluminum (6061) or Copper (OFHC) Waveguide Available

WAVEGUIDE FLANGES:

A = AMC QUICK DISCONNECT (MALE) PATENT PROTECTED

B = AMC QUICK DISCONNECT (FEMALE) PATENT PROTECTED

C = MODIFIED CPR STYLE - GROOVE ONLY, NO CONTACTS (CLEAR HOLES)

D = MODIFIED CPR STYLE - GROOVE ONLY, NO CONTACTS (ALL TAP HOLES)

E = CPR STYLE FLAT (ALL TAP HOLES)

F = CPR STYLE FLAT (CLEAR HOLES)

G = CPR STYLE CONTACT GROOVED(CLEAR HOLES)

H = CPR STYLE CONTACT GROOVED (ALL TAP HOLES)

- I = CMR (CLEAR HOLES)
- J = CMR (ALT/ TAP,/CLEAR HOLES)
- K = CMR (ALL TAP HOLES)
- L = UG COVER (CLEAR HOLES)
- M = UG COVER (ALL TAP HOLES)
- N = UG COVER GROOVED (ALL CLEAR HOLES)
- O = UG CHOKE (CLEAR HOLES)
- P = UG CHOKE (ALL TAP HOLES)
- Q = UG COVER GROOVED (ALL TAP HOLES)
- R = UBR
- S = PBR
- T = CBR
- U = UDR
- V = PDR
- W = CDR
- X = SPECIAL FLANGES (CUSTOMER TO SPECIFY)

SAMPLE P/N: AMC-S75-L-B

MODEL No.	Waveguide Size	FLANGE Type	MATERIAL A=Aluminum B=Brass
AMC-S	75	L	B

The above referenced part number describes the following Item: WR 75 waveguide to coaxial adapter type "SMA" With a cover flange in brass. All connectors are female unless specified.

Waveguide To Coaxial Diagram

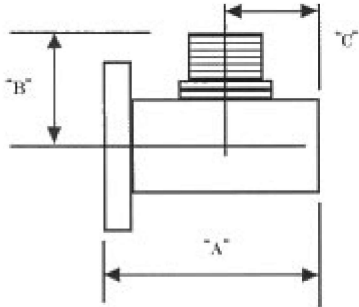

WR SIZE	FREQ: GHZ	DIM. A	DIM. B	DIM. C
28	26.5 - 40.0	1.25	0.565	2.50
34	22.0 - 33.0	1.20	0.62	0.25
42	18.0 - 26.5	1.25	0.62	0.27
51	15.0 - 22.0	1.13	0.65	0.25
62	12.4 - 18.0	1.29	0.66	0.29
75	10.0 - 15.0	1.32	0.71	0.32
90	8.20 - 12.4	1.28	0.71	0.38
102	7.00 - 11.0	1.41	0.78	0.50
112	7.05 - 10.0	1.60	0.78	0.60
137	5.85 - 8.20	1.50	0.85	0.51
159	4.90 - 7.05	1.75	0.96	0.70
187	3.95 - 5.85	2.50	0.94	0.63
229	3.30 - 4.90	2.40	1.15	0.90
284	2.60 - 3.95	2.50	1.25	1.24
430	1.70 - 2.60	4.75	2.00	2.00

CONNECTOR CODES:

S =TYPE SMA COAX. CONNECTOR FEMALE.

SM =TYPE SMA COAX. CONNECTOR MALE.

NOTE: SMA FEMALE IS STANDARD

Note: All models include an iridite/ corrosion Protection treatment, painted flat black, flanges are unplated, Iridited and polished. For other flange finishes, material or Paint color requirements please specify

