

SPECIFICATIONS

FREQUENCY BAND Rx: 7.25 - 7.75 GHz
Tx: 7.90 - 8.40 GHz

INSERTION LOSS Rx: 0.45 dB TYP
: 0.55 dB MAX @ 7.25 GHz
Tx: 0.40 dB TYP
: 0.60 dB MAX @ 7.90 GHz

VSWR Rx: 1.25:1 MAX
Tx: 1.25:1 MAX

ISOLATION : 110 dB MIN < 7.00 GHz
PORT TO PORT : 110 dB MIN @ 7.25 - 7.75 GHz
: 110 dB MIN @ 7.90 - 8.40 GHz
: 70 dB MIN @ 7.75 - 7.90 GHz
: 110 dB MIN @ 7.90 - 10.20 GHz

AXIAL RATIO Rx: 1.20 dB MAX
Tx: 1.50 dB MAX

POLARIZATION Rx: LHCP
Tx: RHCP

PRESSURIZATION : SEALED TO 5.0 PSIG

FINISH
FLANGE FACES : CHROMATE CONVERSION COATED \diamond C
PER MIL-DTL-5541F, TYPE II, CLASS 1A

EXTERIOR : \triangle 1

REVISIONS				
ZONE	REV.	DESCRIPTION	DATE	APPROVED
	B	SEE DR № 12216	2015-12-05	J. Davis
\diamond C	C	SEE CN № 13501	2015-10-08	J. Mitchell

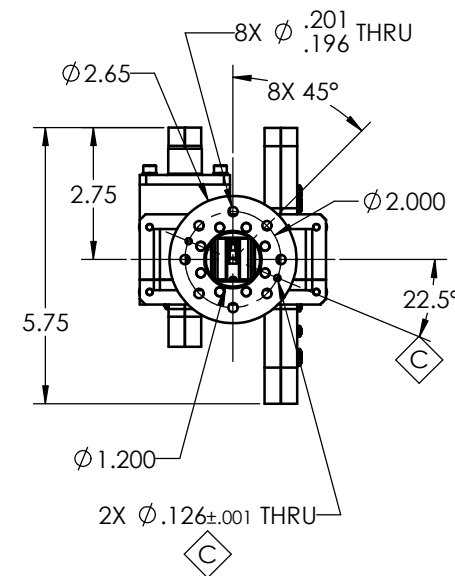
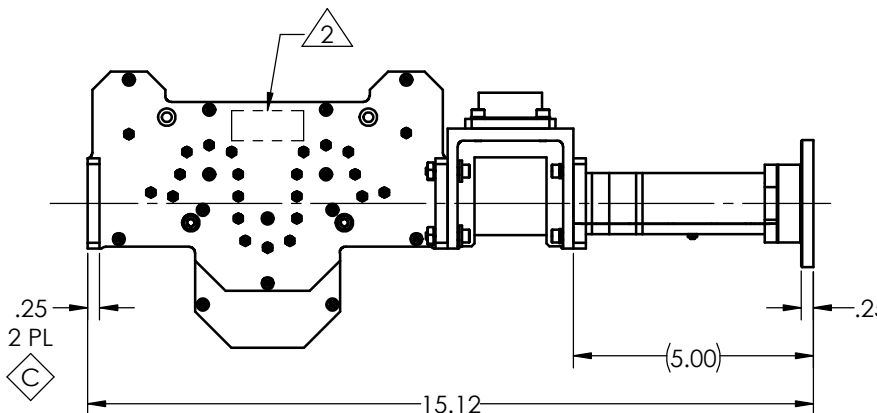
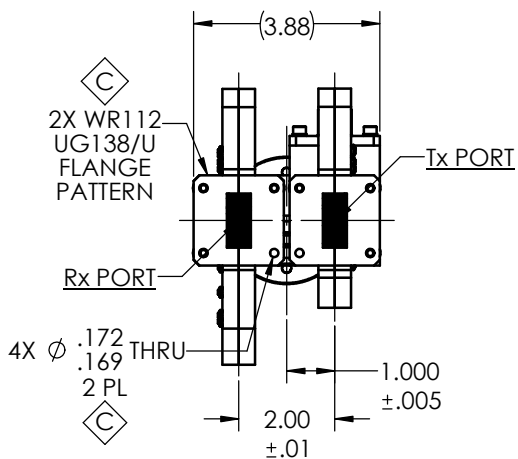
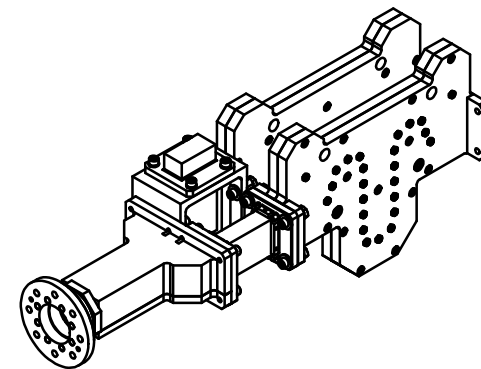

\triangle 2 APPLY IDENTIFICATION LABEL APPROXIMATELY WHERE INDICATED.

\triangle 1 NOMENCLATURE FOR EXTERIOR FINISH OPTIONS:

- * 114450-7C UNPAINTED CHROMATE CONVERSION COATED
- * 114450-7W WHITE PAINT, COLOR № 17875 PER FED-STD-595
- * 114450-7B BLACK PAINT, COLOR № 37038 PER FED-STD-595
- * 114450-7G GREEN PAINT, COLOR № 34096 PER FED-STD-595
- * 114450-7S SANDSTONE PAINT, COLOR № 33510 PER FED-STD-595

NOTES: UNLESS OTHERWISE SPECIFIED.

UNLESS OTHERWISE SPECIFIED INTERPRET DIMENSIONING & TOLERANCING PER ANSI Y14.5M-1992. DIMENSIONS ARE IN INCHES. DIMENSIONS SHOWN IN () ARE FOR REFERENCE ONLY. TOLERANCES ARE: SURFACE- TOLERANCES- 32 .XX ±.03 .XXX ±.004 .XXXX ± ANGLES ±0°30'	APPROVALS	DATE	GENERAL DYNAMICS PROPRIETARY		
	DRAWN: JACK DAVIS	09-25-12	GENERAL DYNAMICS		
	CHECKED:		SATCOM Technologies		
	ENGR:		3111 Fujita Street, Torrance CA 90505, (310) 539-6704		
MFG:			2-PORT CP, X-BAND		
QA:			SIZE	FSCM №	DWG №
EAR CONTROLLED: Export or re-export subject to 15 CFR 700 - 799			C	50478	114450-7
MATERIAL: - SEE PARTS LIST -			SCALE: 1:2		REV C
					SHEET 1