

# SPECIFICATION

## REVISIONS

**FREQUENCY BAND** Rx: 7.25 - 7.75 GHz  
Tx: 7.90 - 8.40 GHz

**INSERTION LOSS** Rx: 0.65 dB MAX  
Tx: 0.75 dB MAX

**VSWR** Rx: 1.3:1 MAX  
Tx: 1.3:1 MAX

**ISOLATION**  
PORT TO PORT: 120 dB MIN < 7.00 GHz  
: 120 dB MIN @ 7.25- 7.75 GHz  
: 50 dB MIN @ 7.75- 7.90 GHz  
: 90 dB MIN @ 7.90-10.20 GHz

**AXIAL RATIO** Rx: 0.5 dB MAX  
Tx: 0.5 dB MAX

**POWER HANDLING:** 1.0 kW PER Tx PORT

**PRESSURIZATION:** SEALED TO 5.0 PSIG

**FINISH** Rx/Tx  
**FLANGE FACES:** ZINC-NICKEL PLATED PER AMS 2417G, TYPE II, CLASS 2

**COMMON PORT**  
**FLANGE FACE:** CHROMATE CONVERSION COATED PER MIL-DTL-5541F, CLASS 1A

**EXTERIOR:** SEE NOTE 1

REV	DESCRIPTION	DATE	APPROVED
A	REVISED PER DR 11935		

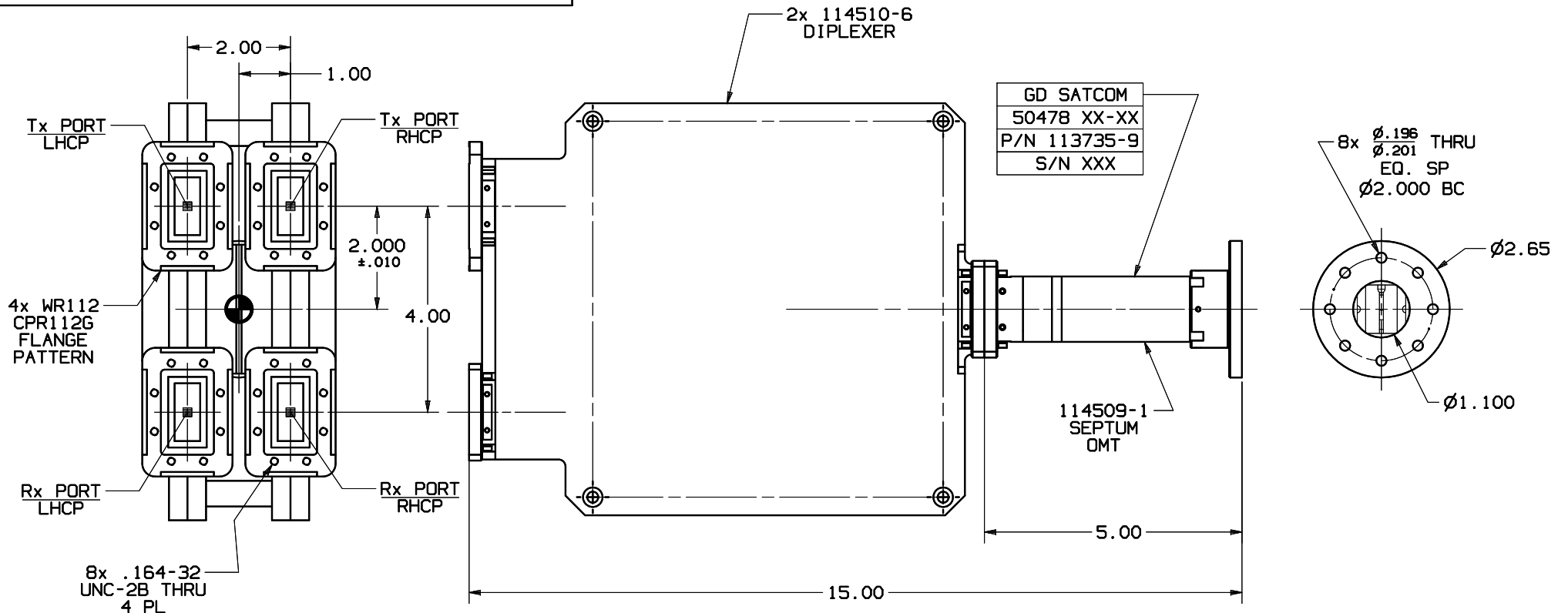

P/N: 113735-\_\_\_\_\_  
(COMPLETE P/N REQUIRES DASH NO.)

1 NOMENCLATURE FOR EXTERIOR FINISH OPTIONS:			DASH
113735-9W	WHITE PAINT, COLOR No 17875 PER FED-STD-595		9W
113735-9B	BLACK PAINT, COLOR No 37038 PER FED-STD-595		9B
113735-9G	GREEN PAINT, COLOR No 34096 PER FED-STD-595		9G
113735-9S	SANDSTONE PAINT, COLOR No 33510 PER FED-STD-595		9S

NOTES: UNLESS OTHERWISE SPECIFIED.

UNLESS OTHERWISE SPECIFIED	APPROVALS	DATE
INTERPRET DIMENSIONING & TOLERANCING PER ANSI Y14.5M-1982. DIMENSIONS ARE IN INCHES. DIMENSIONS SHOWN IN ( ) ARE FOR REFERENCE ONLY. TOLERANCES ARE:  SURFACE- TOLERANCES- .XX ±.02 .XXX ±.004 .XXXX ± ANGLES ±0°30'  MATERIAL:	DRAWN: TOVAL IN	03-05-12
	CHECKED:	
	ENGR:	
	WFB:	
<b>EAR CONTROLLED:</b>		
Export or re-export subject to 15 CFR 700-799.		

GENERAL DYNAMICS PROPRIETARY			
<b>GENERAL DYNAMICS</b>			
SATCOM Technologies			
3111 Fujita St., Torrance, CA 90505, (310) 539-6704			
<b>X-BAND 4-PORT DIPLEXER, CIRCULAR POLARIZED "CONVENTIONAL"</b>			
SIZE	FSCM No	DWG No	REV
C	50478	113735-9	A
SCALE:	3:8	SHEET	1