

SPECIFICATIONS

FREQUENCY BAND : 13.75 - 14.50 GHz
 INSERTION LOSS : 0.30 dB MAX
 VSWR : 1.30:1 MAX
 ISOLATION : 70 dB MIN AT 10.70-12.75 GHz
 AND 50 dB MIN AT 13.05 GHz
 POWER HANDLING : 400 WATTS CW
 PRESSURIZATION : SEALED TO 5 PSI
 FINISH
 FLANGE FACES: ZINC-NICKEL PLATED PER AMS-2417G
 TYPE II CLASS 2
 EXTERIOR: WHITE PAINT, COLOR #17875 PER
 FED-STD-595

REVISIONS

REV	DESCRIPTION	EFFECTIVE DATE	APPROVED BY
E	DR# 10099	4-14-11	M.LANES

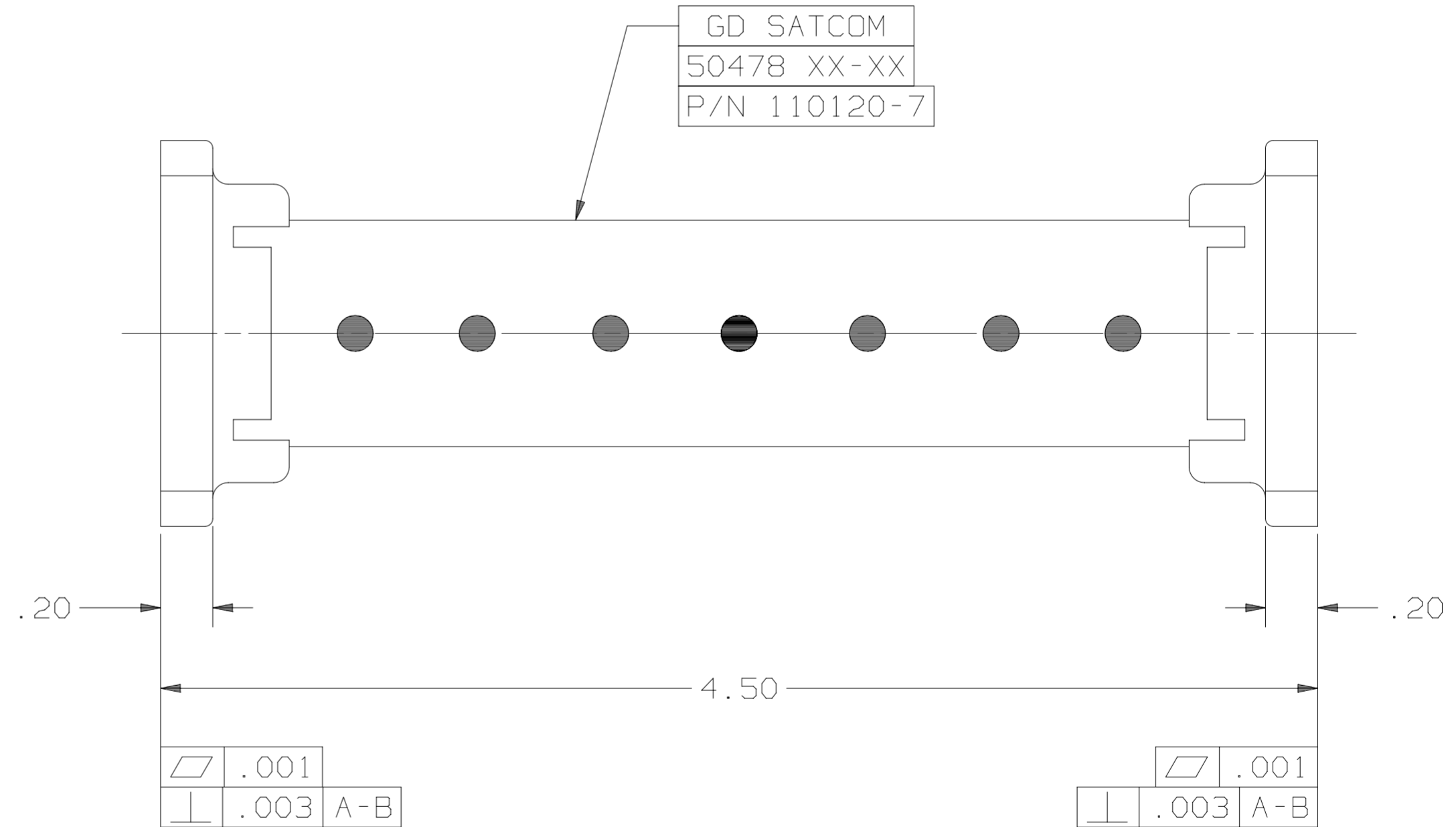
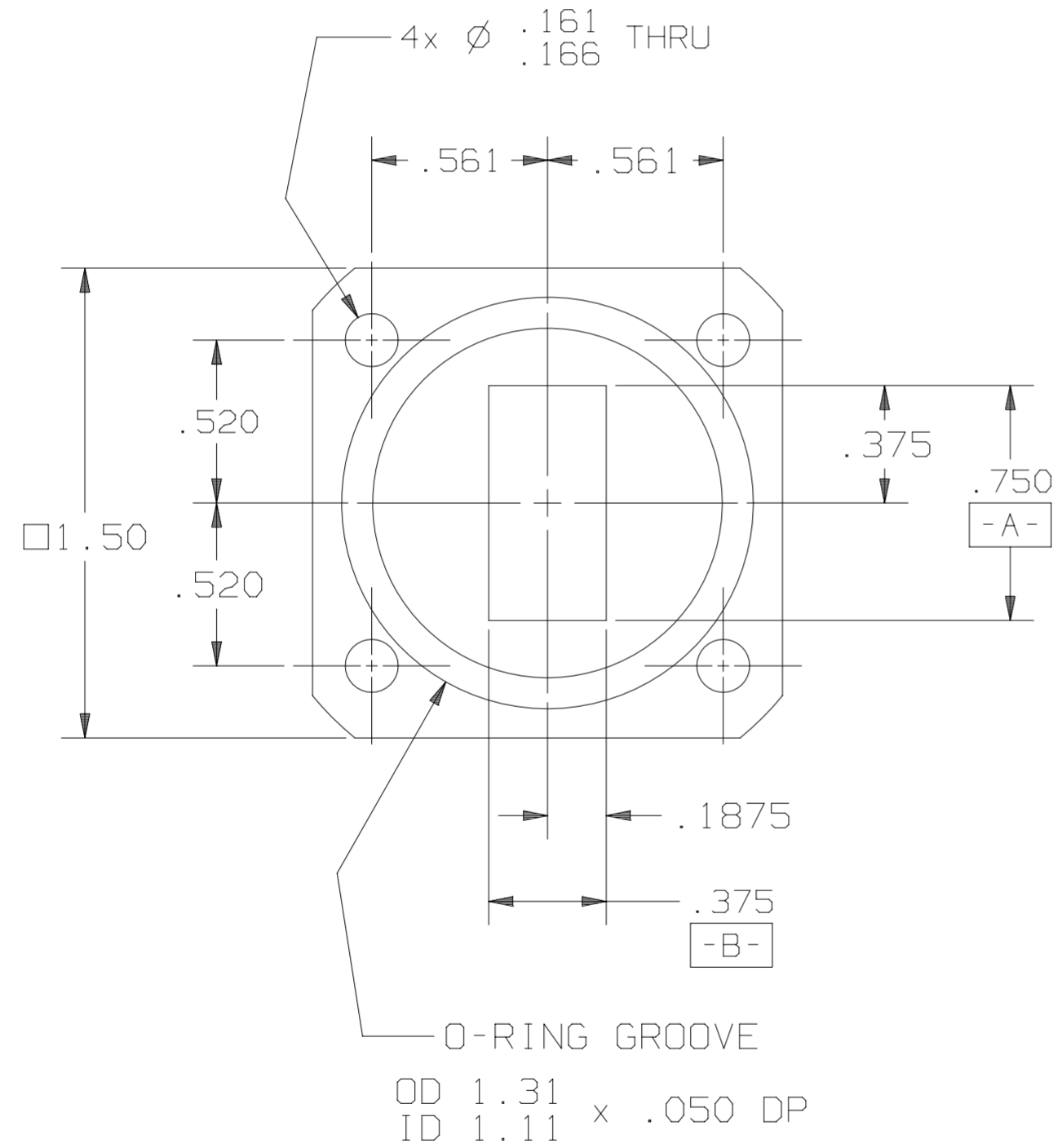

BOTH FLANGES

UNLESS OTHERWISE SPECIFIED		APPROVALS	DATE	GENERAL DYNAMICS PROPRIETARY	
INTERPRET DIMENSIONING & TOLERANCING PER ANSI Y14.5M-1982. DIMENSIONS ARE IN INCHES. DIMENSIONS SHOWN IN () ARE FOR REFERENCE ONLY. TOLERANCES ARE: SURFACE- TOLERANCES- .XX ±.02 .XXX ±.003 .XXXX ±.0015 ANGLES ±0°30' MATERIAL:		DRAWN: L. Tovalin	05-07-00	GENERAL DYNAMICS SATCOM Technologies 3111 Fujita St., Torrance, CA 90505, (310) 539-6704	
		CHECKED: H. Spieleder	06-23-09		
		EAR CONTROLLED:		Ku-BAND BANDPASS FILTER	
		Export or re-export subject to 15 CFR 700-799.			
SIZE		FSCM No.	DWG No.	REV	
C		50478	110120-7	E	
SCALE: 2:1		SHEET		1	

NOTES: UNLESS OTHERWISE SPECIFIED.